

GIC Machines - VFB8000



VFB8000

- High speed continuous motion machine.
- Latest generation maintenance free servo motor drives for all main machine movements – film feed, crimp jaw opening/closing, and crimp jaw vertical movements.
- 10 inch colour Allen Bradley full feature operator HMI touch screen.
- Multiple access levels for operators, engineers, machine setters and management, each level password protected.
- Proven robust mechanical and electrical design, ensure industry leading reliability and low cost of ownership.
- Standard large capacity low level reel mounting.
- Only the highest quality materials and components are used to satisfy the most demanding environments.
- Maximum access for clean-down and maintenance.
- Available as either a stand-alone unit, complete with feed system, or part of a turnkey solution.
- The machine can be tailored to the Customers specification by our in house design team.

General Information

Standard Features

Icon driven | Recipe memory for push button size change | Multiple access levels with password protection | Integral temperature control | Full machine status display | Stainless steel & hard anodised aluminium construction | Vacuum transport with dry valve vacuum pump

Optional Features

Full stainless steel construction | Polyethylene sealing system (impulse welding) | Gas flushing | Static eliminator | Bag shaker | Deflator unit | Finish bag take-away elevator | Remote diagnostics dial in facility | Overprinter | Selectable multi-pull transport cycles | Adjustable pack support | Print Registration unit | Twin film reels



machine shown with optional stainless steel doors and swing arm for operator HMI touch-screen

VFB 8000



The GIC VFB8000 has been used in the following applications.

Applications

Fresh & Frozen Produce | Snacks & Confectionery | Industrial Hardware | Pulses & Powders | Liquids

Bag Styles

Pillow | Gusset | Block Bottom | Euroslot | Punch Hole | Easy Open / Reclose with zip

Feed System Options

Augers | Linear weighers | Multi-head weighers | Counters | Volumetric fillers | Liquid pumps | Bucket elevators

Technical Specification - VFB8000

Weight: 1100kg

Maximum Pack Sizes: 400mm Wide x 500mm Long

Maximum Speed: 115 packs per min

Power Supply: 415V 3-phase 3kW (4kW for servo option)

Compressed Air: Free air – 0.06 cubic mtrs/min dependent on speed and application.

Finish: Stainless steel and anodised aluminium

Packaging Materials: All suitable heat sealable materials including laminates and polyethylenes (optional impulse sealing).

Reel Outer Diameter: 480mm (max reel weight 90kg)

Reel Core Diameter: 76mm

Technical Diagrams - VFB8000 (model shown with right hand HMI)

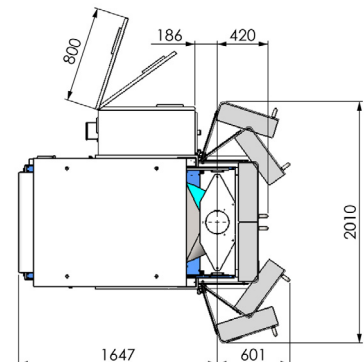
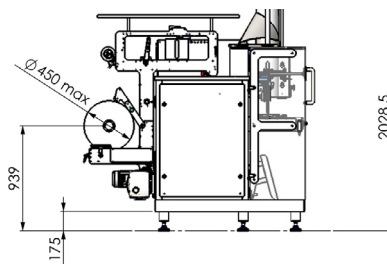
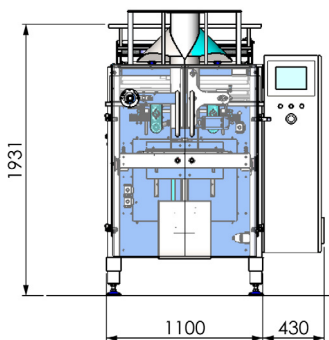

GIC Ltd, Alpha Works, Sandars Road, Heapham Road Industrial Estate, Gainsborough, Lincolnshire, DN21 1RZ

Tel: +44 (0)1427 611885 | Email: info@gic.uk.net | Web: www.gic.uk.net

For all enquiries in the North of England & Scotland Call Andy Beal on: 07711 487387
For all enquires in the South of England & Wales call Keith Marrow on: 07872 129272